



INDOOR COVID-19 POLICIES & PROCEDURES

WSF SOCCER SOUTH & WSF SOCCER NORTH

All users of the facility must review the policies and procedures contained within this information package.

It is the league or group representative's responsibility to distribute this information to all participants and ensure they understand and will adhere to these policies and procedures.

If your group requires assistance, please contact the Winnipeg Soccer Federation in advance of your rental date to discuss how we can assist you.

MASKS ARE MANDATORY AT THE FACILITY. ALL PATRONS ARE RESPONSIBLE TO SUPPLY THEIR OWN MASKS.

- Masks must be worn by players, team officials, and referees before and after games. It is optional to wear the masks during play.
- All spectators must wear masks for the full duration of time they are inside the facility.
- Masks are available to purchase for \$1 at the Information Booth.

COVID-19 PROCEDURE OVERVIEW

- **FIELD ENTER/EXIT PROCEDURES:** The procedures for how teams proceed to and from the field has changed. Please review the attached information and field level maps.
- **SPECTATORS:** Spectators are not allowed for adult games. For youth games, one spectator per player is allowed and must go directly to the concourse level upon arrival at the facility (no field level access). If you need to assist your child, please do so on the concourse level before they proceed to their assigned field.
- **NO CHANGE ROOMS:** All participants are to arrive dressed to play (indoor shoes changed on-site). Designated dressing rooms will be available for washroom purposes only. No changing or showering in these rooms.
- **HAND SANITIZER:** Pumps are available at the facilities. Everyone must also bring their own for personal use.
- **DISINFECTING PROCEDURES:** Areas of the field (benches and surrounding area, flags and nets) will be disinfected between every game. Additional cleaning will also be done in the washroom and concourse areas.
- **PHYSICAL DISTANCING:** Physical distancing is to be practiced in all areas of the facility at all times, including the team waiting areas, seating areas, main foyer and concourse level.
- **POLICIES & PROCEDURES:** All policies and procedures set forth by the Province of Manitoba, Manitoba Soccer Association, Winnipeg Soccer Federation and your associate league must be followed at all times. Failure to do so may result in your removal from the facility.
- **COVID-19 PHASES:** These policies and procedures are set in place as per the Province of Manitoba's current phase for COVID-19 and may be adjusted if needed.

REVIEW THE PROVINCE OF MANITOBA'S COVID-19 PRE-SCREENING TOOL PRIOR TO ARRIVING AT THE FACILITY. IF YOU HAVE SYMPTOMS, DO NOT ENTER THE FACILITY AND START FOLLOWING COVID-19 PROCEDURES IMMEDIATELY.



INDOOR FACILITY GAME PROCEDURES

WSF SOCCER SOUTH & WSF SOCCER NORTH

REVIEW THE PROVINCE OF MANITOBA'S COVID-19 PRE-SCREENING TOOL PRIOR TO OR UPON ARRIVAL AT THE FACILITY. IF YOU HAVE ANY SYMPTOMS, DO NOT ENTER THE FACILITY AND START FOLLOWING COVID-19 PROCEDURES IMMEDIATELY.

The Winnipeg Soccer Federation is committed to providing a healthy sports environment. Our indoor facilities are over five stories high and are equipped with extensive ventilation systems that provide fresh air into the buildings. Our systems remove air from the buildings and provide fresh air every 20-30 minutes. Air quality testing has shown readings for ambient air quality equivalent to outdoor fresh air standards.

The WSF have also set new policies and procedures in place to provide the opportunity to play safely and physical distance as much as possible. These include wearing masks, having designated entrances and exits for the facilities and fields, additional hand sanitizer stations and increased disinfecting and cleaning practices. WSF staff are on-hand throughout the facility to provide guidance and answer questions.

MASKS ARE MANDATORY AT THE FACILITY. ALL PATRONS ARE RESPONSIBLE FOR SUPPLYING THEIR OWN MASKS.

Masks must be worn by players, team officials and referees before and after games. It is optional to wear masks during play. All spectators must wear masks for the full duration of time they are inside the facility. If needed, masks are available to purchase for \$1 at the Information Booth.

GAME PROCEDURES

PRE-GAME PROCEDURES

- Review the attached field level maps for the south and north facilities to acquaint yourself with where you are to go once you arrive at the facility.
- Arrive within 15 minutes prior to the start of your game. There will be no field level access prior to this time.
- Be dressed and ready to play. If possible, change into your playing shoes once inside the facility.
- Select dressing rooms will be available to use for washroom purposes only. No changing or showering will be allowed.
- Upon arrival, proceed directly to the team waiting areas beside your assigned playing field. **Do not remove your mask and spread out as much as possible to adhere to physical distancing guidelines.**
- **YOUTH PLAYERS:** You may meet your coach on the concourse level and proceed to the playing field as a group. Parents and spectators are not allowed at field level.
- Do not enter your assigned field until the WSF staff have finished the disinfecting process and give clearance to proceed.
- After clearance, proceed through the designated field entrance to your bench area and place your personal belongings behind your bench. Please do not bring valuables into the facility. The WSF is not responsible for lost or stolen items.
- There is limited space at the bench areas. Please physical distance on the sidelines when not playing.
- Players, team officials and referees may remove the mask during the game while on the field areas and in technical areas.

POST-GAME PROCEDURES

- Time is limited between games so do not linger. Quickly change into your outdoor attire and collect your belongings.
- **Put your mask back on before departing the bench area.**
- Proceed quickly to your designated field exit, proceed up to the concourse through your designated field level door and then continue out the main doors of the facility to exit.
- All players and spectators are to exit as quickly as possible. Do not congregate on the concourse or at the exit areas.
- **YOUTH PLAYERS:** Parents are to arrange to meet their children on the concourse level after the game. There will be no loitering allowed at the main entrances/exits of the facilities.

Adjustments may be made to these procedures.

Please follow the guidance of the WSF staff and adhere to the signs posted at the facilities.

Thank you for your cooperation.



WSF SOCCER SOUTH FIELD LEVEL PROCEDURES

Updated as of August 31, 2020

Location: 211 Chancellor Matheson Road (University of MB Campus)

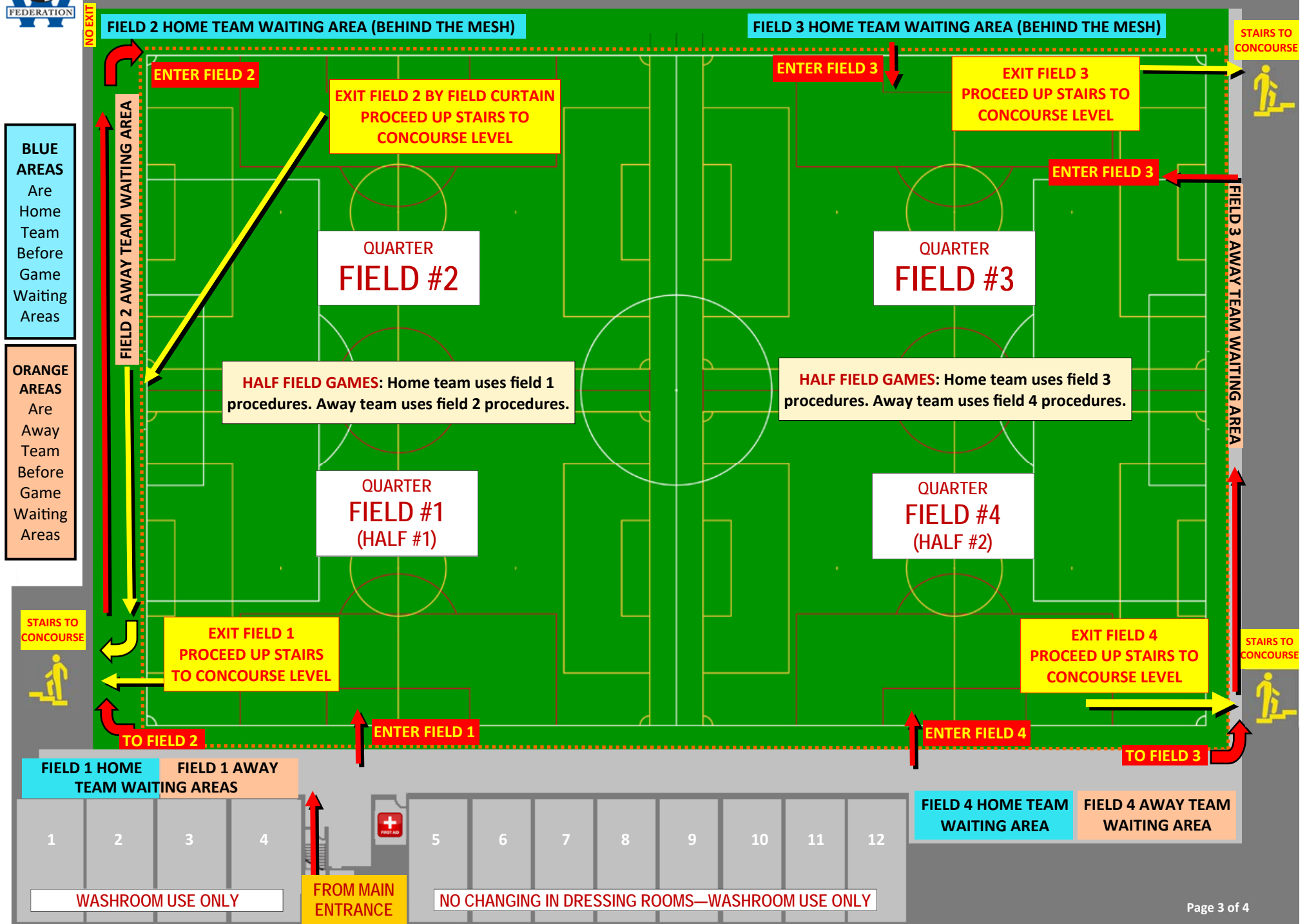



WSF SOCCER NORTH FIELD LEVEL PROCEDURES

Updated as of August 31, 2020

Location: 770 Leila Avenue (Garden City)

